

REVISION				
ZONE	REV	FROM	TO	DATE

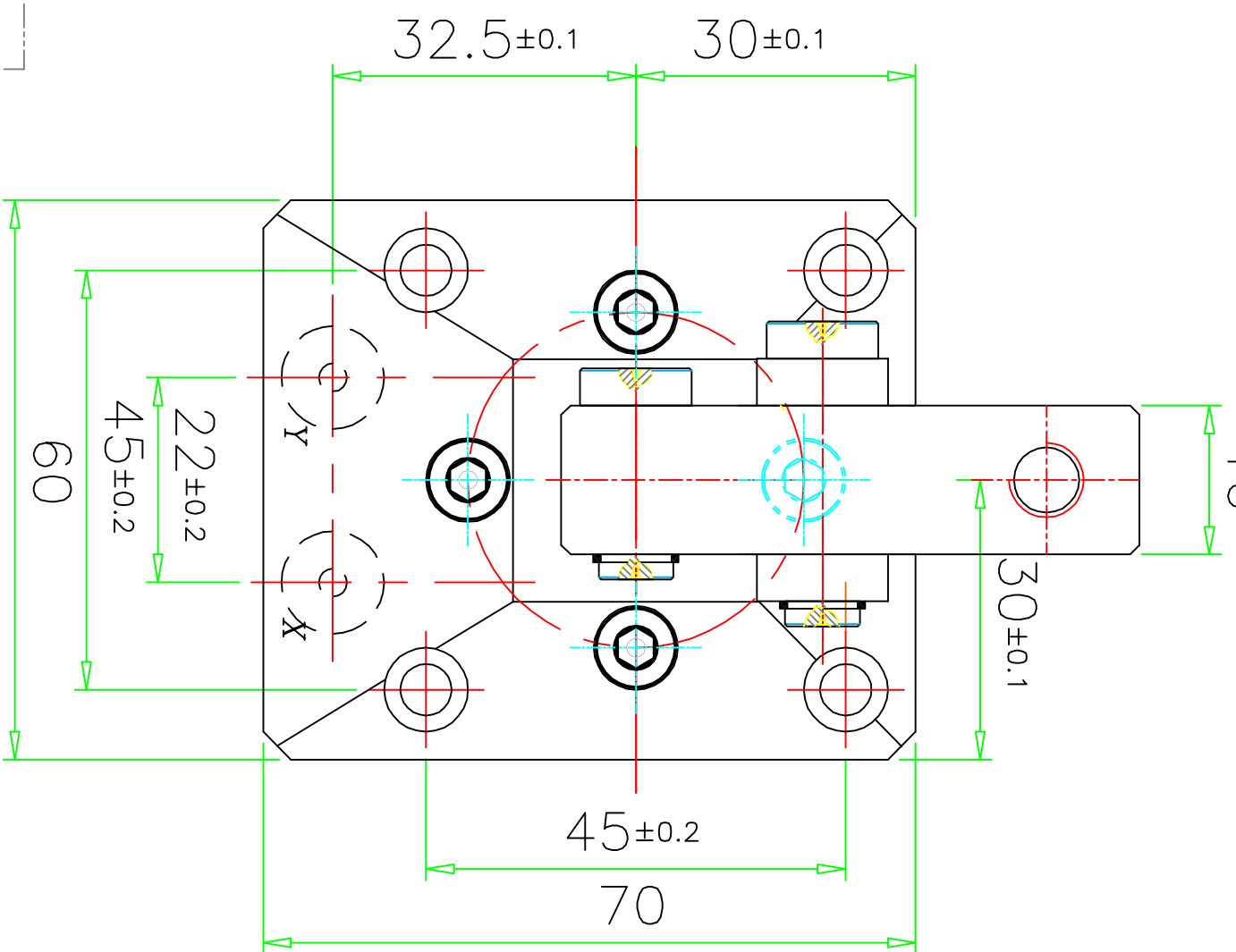
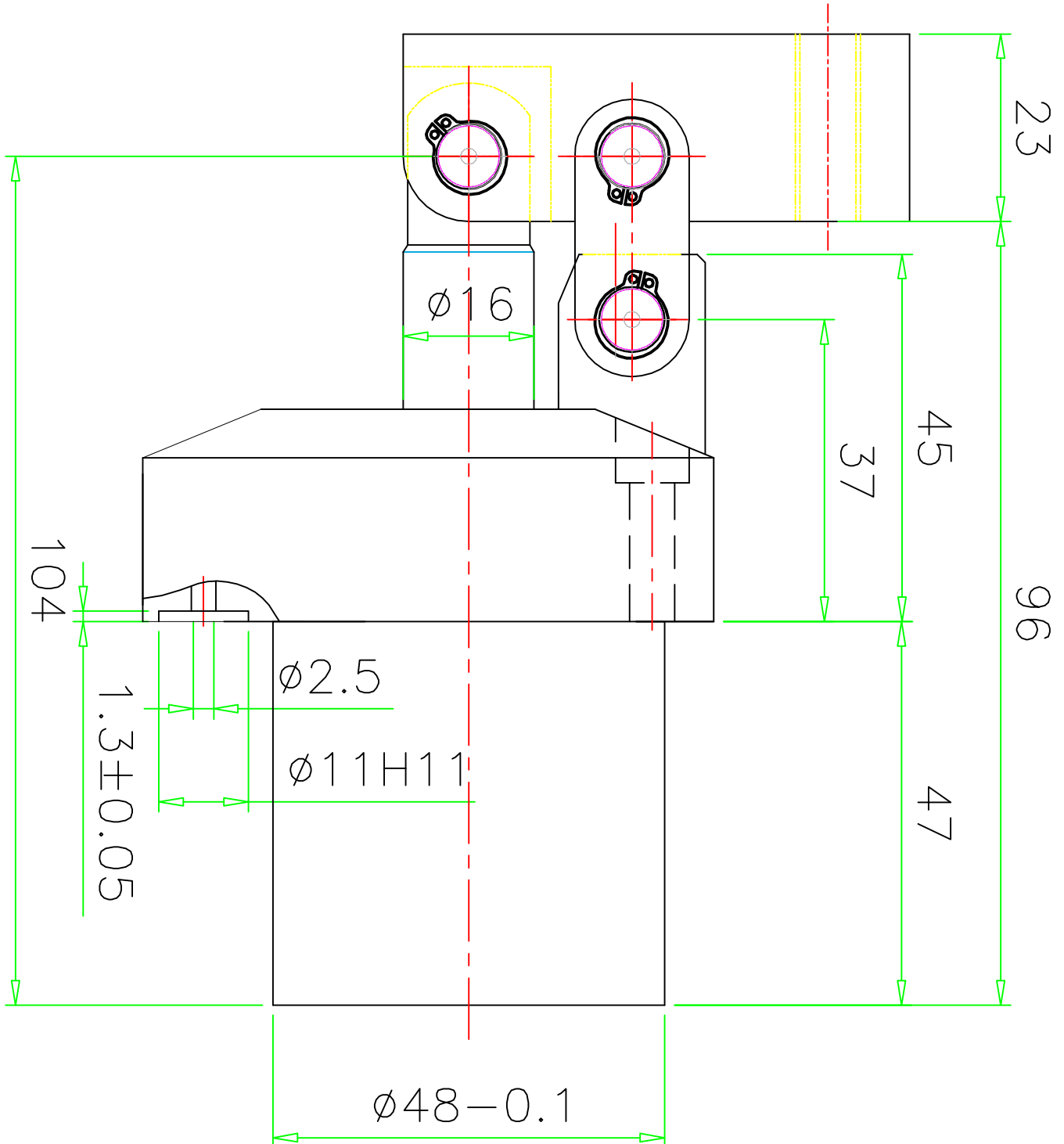

X - Clamp part  
Y - Declamp part

**Specification:-**  
Type : Doble acting hydraulic cylinder.  
Bore dia = 25 mm, rod dia = 16 mm  
Stroke = 20; Reserve Stroke = 2 mm  
Operating pressure : max 150 bar/min 25 bar  
Medium :Hydraulic oil  
(servo system HLP46/HLP68)

- 1.0 GENERAL**
- 1.1 ALL DIMENSIONS ARE IN MM.
  - 1.2 DO NOT SCALE THE DRG.IF IN DOUBT ASK.
  - 1.3 SUBJECT TO CHANGE FOR IMPROVEMENT.

SURFACE FINISH		▽▽▽	▽▽▽	▽▽	▽	▽	~
Re value $\mu m$		0.025	0.05	0.1	0.2	0.4	0.8
LINEAR - LENGTH OR DIAMETER		30-120	120-315	315-1000	1000-2000	UP TO 6	6-30
ANGULAR-LENGTH IN MM OR SHORT SIDE OF		±0.1	±0.2	±0.3	±0.5	±1.2	±1°
SCALE		1:1					
TITLE		VERTICAL SWING CLAMP					
D/A-(MANIFOLD TYPE)							
DESIGN	NAME	DATE	MACHINE TYPE				
TRIRUNAL	TRIRUNAL	05-05-04					
CHECKED		01-08-06					
APPROVED							
GROUP NO.							
SUPERSEDED BY							
REPLACES							
DRAWING NO.		S31301-M					