

174(DE CLAMP CONDITION)

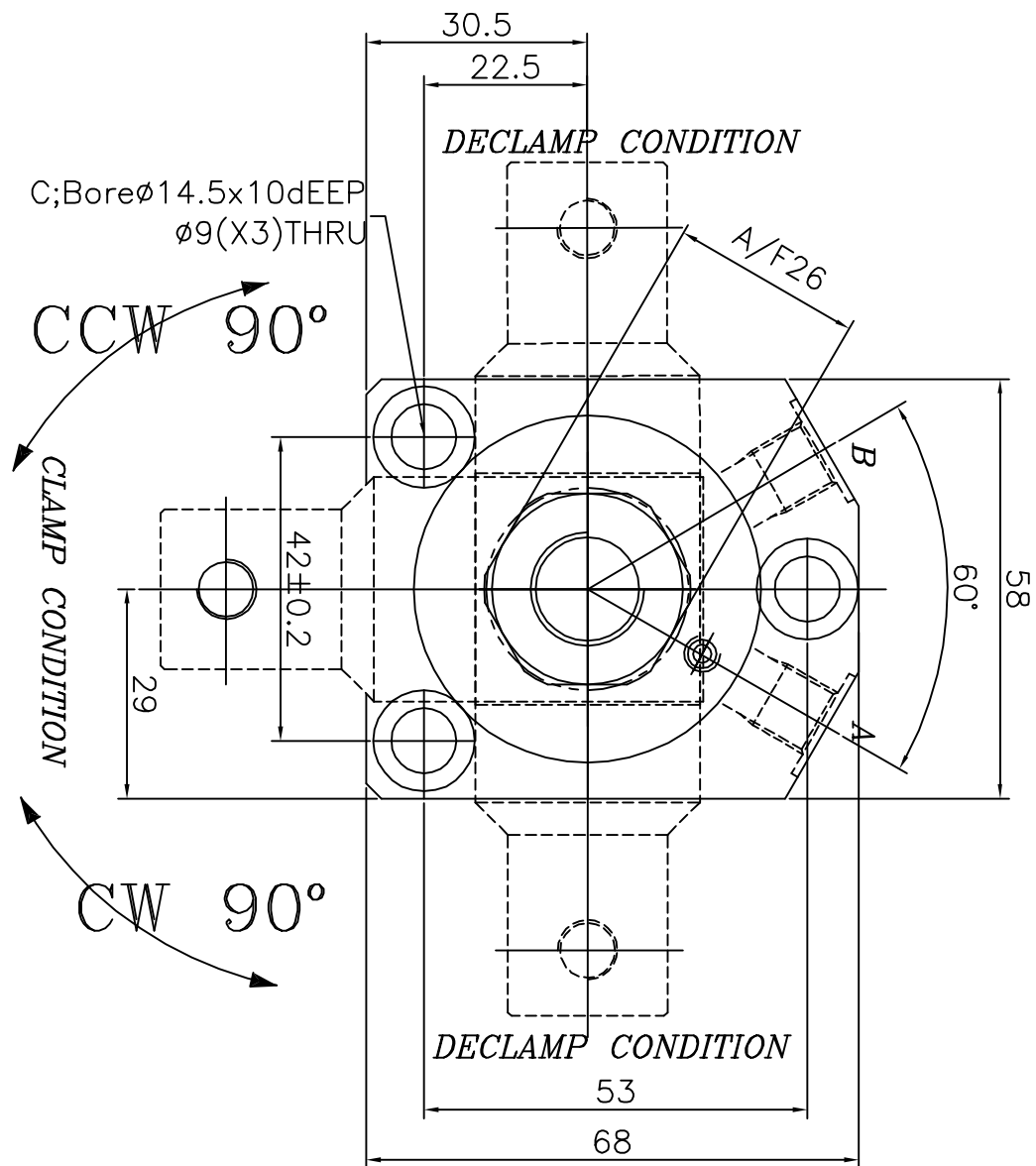
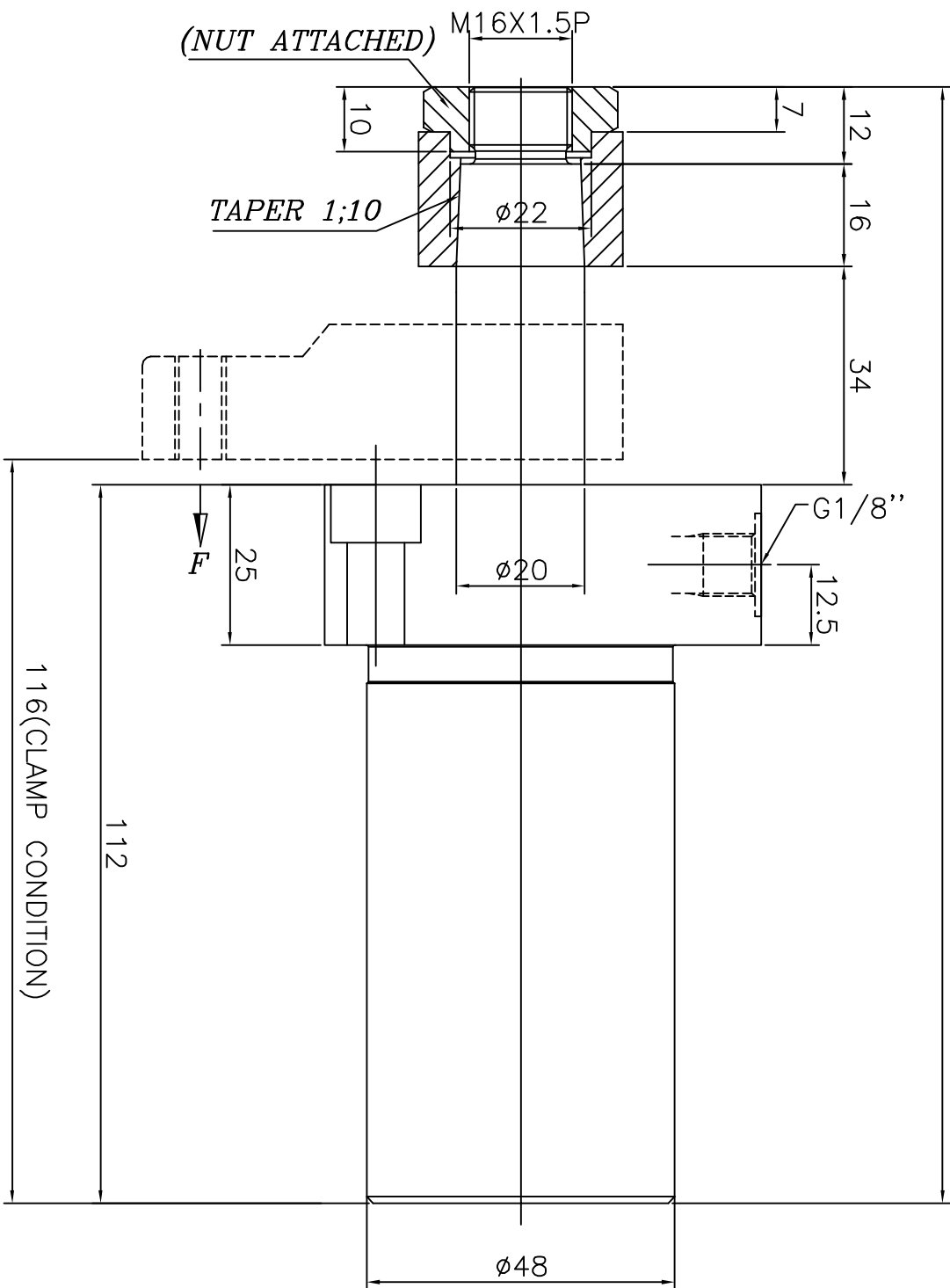

A-Clamp port
B-Declamp port

Specification:-

Type : Doble acting hydraulic cylinder.
Bore dia = 25 mm, rod dia = 20 mm
Clamp Stroke =10; Swing Stroke = 20 mm
Total Stroke = 30
Arm swing will be 90°±2°
Operating pressure : max 250 bar/min 10 bar
Medium :Hydraulic oil
(servo system HLP46/HLP68)

Model NO-C.W-S41301
C.C.W-S41302

- 1.0 GENERAL
- 1.1 ALL DIMENSIONS ARE IN MM.
- 1.2 DO NOT SCALE THE DRG.IF IN DOUBT ASK.
- 1.3 SUBJECT TO CHANGE FOR IMPROVEMENT.

SURFACE FINISH		▽▽▽	▽▽▽	▽▽	▽	~	
Ra value μm		0.025	0.05	0.1	0.2	0.4	0.8
LINEAR - LENGTH OR DIAMETER		0.5-6	6-30	30-120	120-315	315-1000	1000-2000
ANGULAR-LENGTH IN MM OF SHORT SIDE OF ∠		±0.1	±0.2	±0.3	±0.5	±0.8	±1.2
SCALE:		1:1					
DESIGN	TIRUMAL	DATE	22.08.08				
DRAWN	TIRUMAL	MACHINE TYPE					
CHECKED		TITLE					
APPROVED		TOP SWING CLAMP					
CUSTOMER:		DOUBLE ACTING					
DRAWING NO:		-					
GROUP NO:		XXX					
SUPERCEDED BY		-					
REPLACES		-					
MATERIAL:		XXX					
SHEET NO:		1 OF: 1					

REVISION				
ZONE	REV	FRM	TD	DATE

1 2 3 4 5 6 7 8

1 2 3 4 5 6 7 8