

CLAMP CUSTOMER  
SCOPE

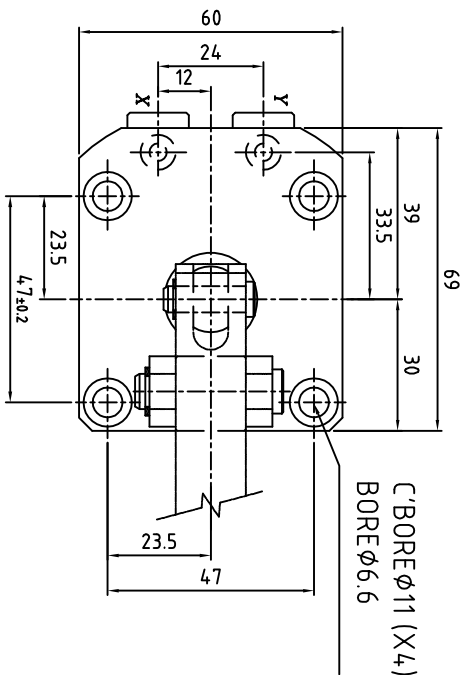
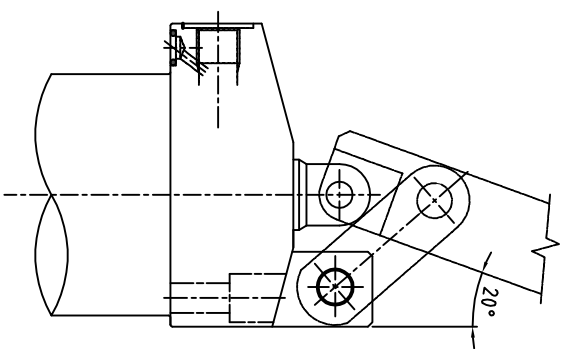
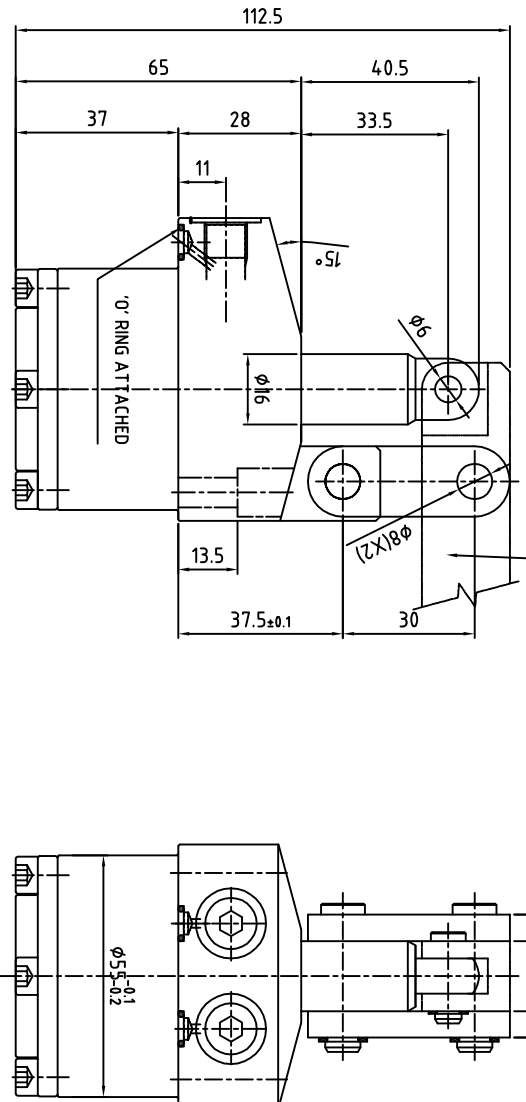

C'BORE  $\phi 11$  (X4)  
BORE  $\phi 6.6$

X - CLAMP PORT  
Y - DECLAMP PORT

Specification:-

Type : Double acting hydraulic cylinder.  
Bore dia = 36 mm, rod dia = 16 mm  
Full Stroke = 26; LockStroke = 23 mm  
Reserve Stroke = 3 mm  
Operating pressure : max 70 bar/min 10 bar  
Medium : Hydraulic oil (servo system HLP46/HLP68)

REVISION				DATE	APPROVED
ZONE	REV	FROM	TO		

SURFACE FINISH	RE VALUE	µm
▽▽▽▽	0.025	0.05
▽▽▽	0.1	0.2
▽▽	0.2	0.4
▽	0.4	0.8
▽	0.8	1.2
▽	1.2	2.5
▽	2.5	5.0
▽	5.0	10.0

LINEAR - LENGTH OR DIAMETER	ANGULAR-LENGTH IN MM OF SHORT SIDE OF ∠	QUICLOC
0.5-6	UP TO 6	PVT LTD
6-30	6-30	B'lore - 70
30-120	30-120	
120-315	120-400	
315-1000	120-400	
1000-2000	120-400	

SCALE	TITLE	MATERIAL	SHEET NO
1:1	VERTICAL SWING CLAMP		OF

DESIGN	DATE	MACHINE TYPE	GROUP NO.
TIRUMAL	10/12/09	Double Acting	

DRAWN	DATE	CUSTOMER	SUPERCEDED BY
TIRUMAL	10/12/09		

CHECKED	DATE	GROUP NO.	REPLACES

APPROVED	DATE	DRAWING NO.
		S35304-CC