

C' BORE-11XDEEP-6.5
ON PCDS0±0.1
ø6.5(X3)HTUR

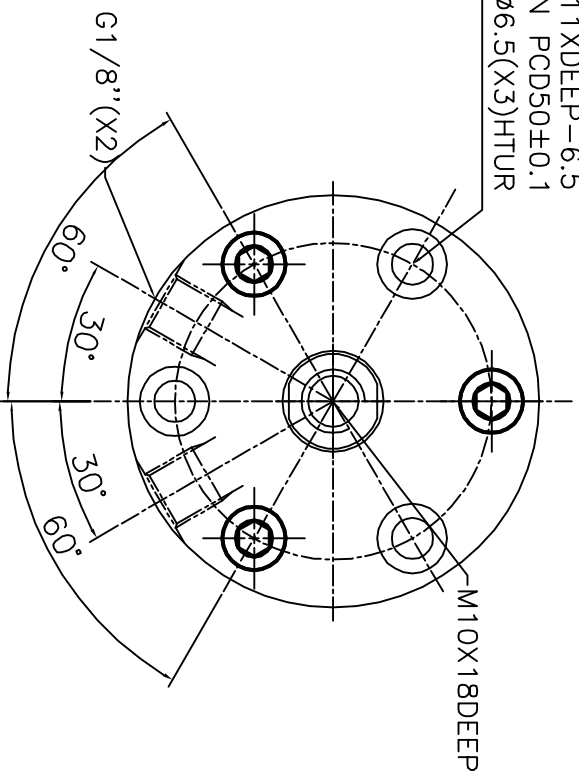

MODEL NO-A61304

Specification:-

Type : Double acting hydraulic cylinder.
Bore dia = 32 mm, rod dia = 16 mm
Stroke = 25 mm
Operating pressure : max 150 bar/min 10 bar
Hydraulic oil : Hydraulic oil (servo system HLP46/HLP68)
Medium

- 1.0 GENERAL
1.1 ALL DIMENSIONS ARE IN MM.
1.2 DO NOT SCALE THE DRG.IF IN DOUBT ASK.
1.3 SUBJECT TO CHANGE FOR IMPROVEMENT.

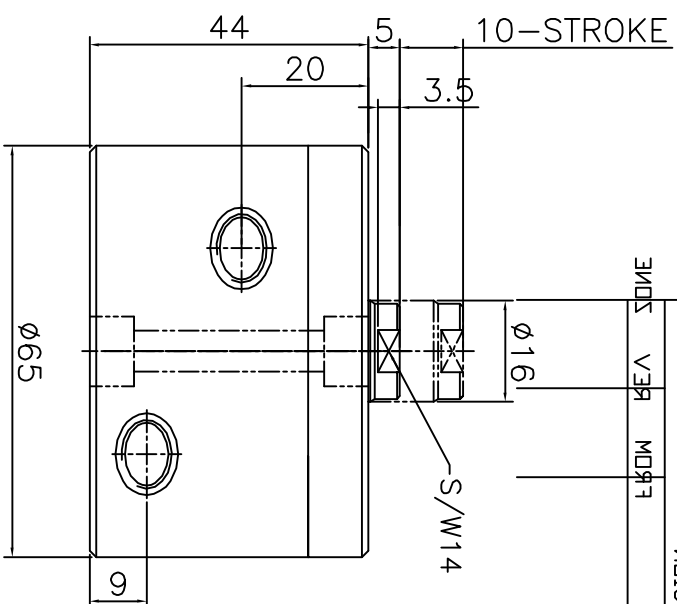

C' BORE-11XDEEP-6.5
ON PCDS0±0.1
ø6.5(X3)HTUR

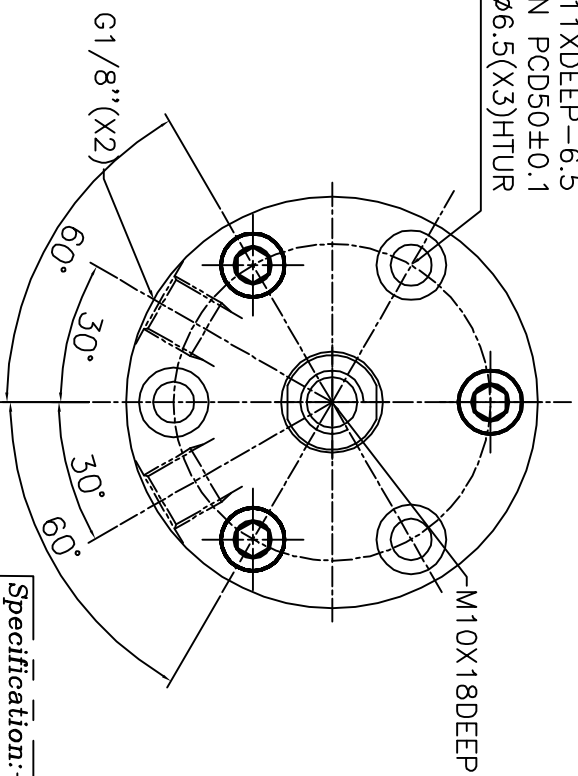

MODEL NO-A61303

Specification:-

Type : Double acting hydraulic cylinder.
Bore dia = 32 mm, rod dia = 16 mm
Stroke = 10 mm
Operating pressure : max 150 bar/min 10 bar
Hydraulic oil : Hydraulic oil (servo system HLP46/HLP68)
Medium

SURFACE FINISH		Ra value µm		0.025		0.05		0.1		0.2		0.4		0.8		1.6		3.2		6.3		12.5		25		50		100	
LINEAR - LENGTH OR DIAMETER		0.5-6	6-30	30-120	120-315	315-1000	1000-2000	UP TO 6	6-30	30-120	120-400	ANGULAR-LENGTH IN MM OF SHORT SIDE OF ∠																	
GENERAL TOLERANCES WHERE NOT SPECIFIED		±0.1	±0.2	±0.3	±0.5	±0.8	±1.2	±1'	±30'	±20'	±10'																		
SCALE:		1:1																											
TITLE		COMPACT CYLINDER																											
NAME		Double acting, single rod end																											
DATE		-																											
DESIGN		TIRUMAL 22.08.08																											
DRAWN		TIRUMAL 22.08.08																											
CHECKED																													
APPROVED																													
MATERIAL:		XXX																											
GROUP NO:																													
SUPERCEDED BY																													
REPLACES																													
DRAWING NO:																													
SHEET NO:		1 OF 1																											
QUICKLOC																													
PVT LTD																													
Blore - 70																													

INDS	VAR	MOD	DT	ITAD

MD121V3R

DT

ITAD