

SHORT STROKE (S)

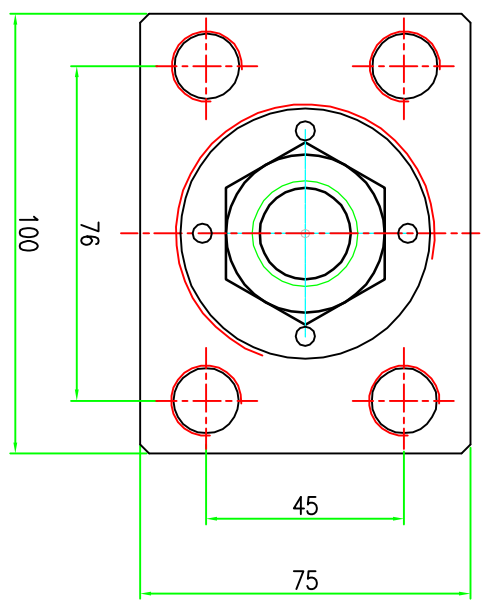
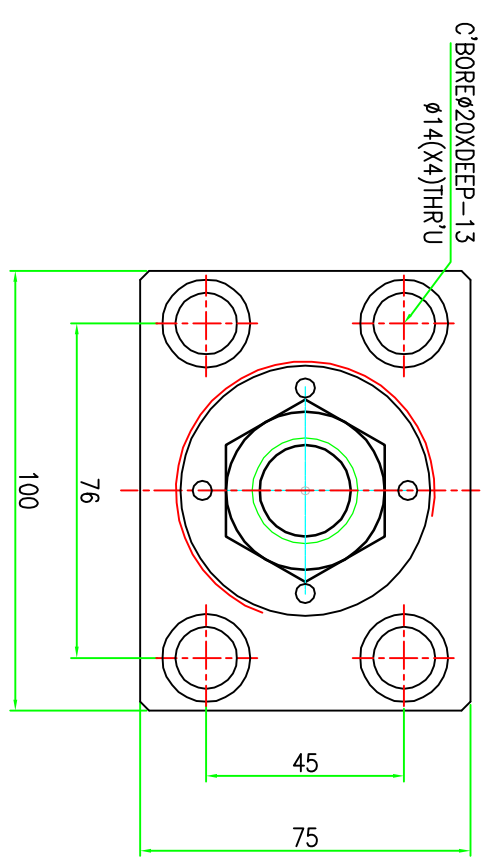
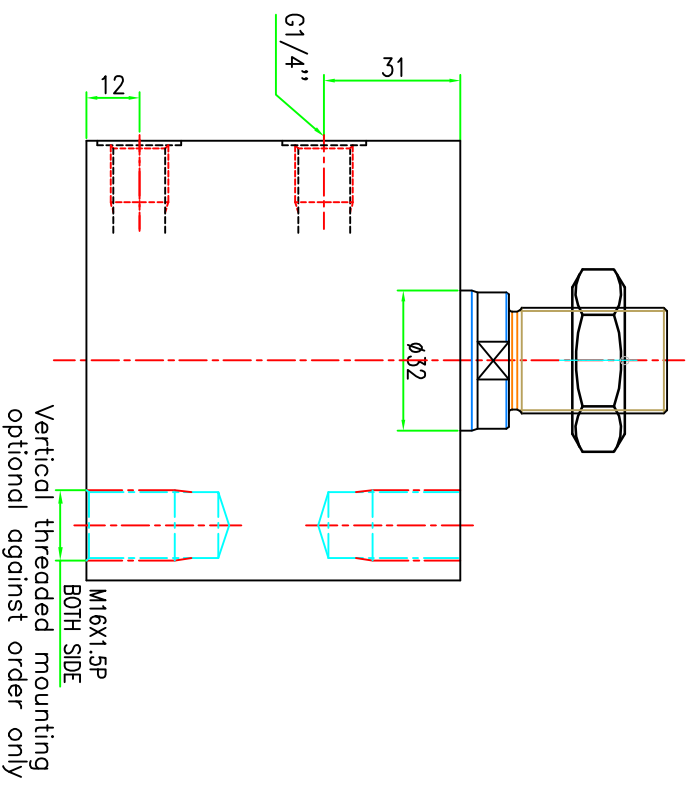
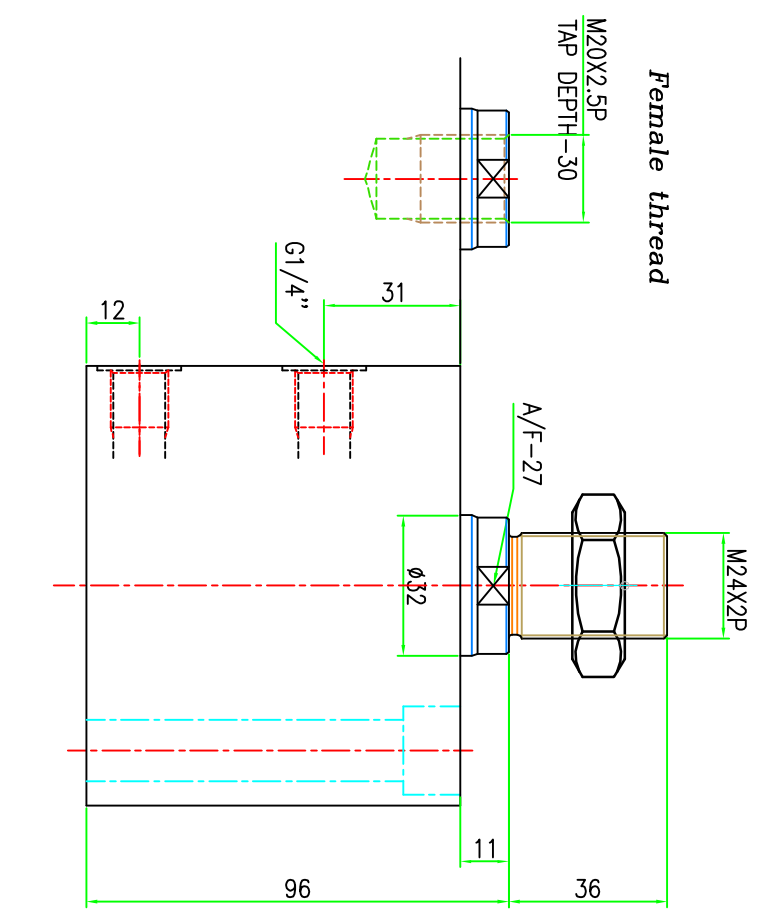

**Model NO-Male thread-A31309**  
**Female thread-A31310**

**Specification:-**  
Type : Double acting hydraulic cylinder.  
Bore dia = 50 mm, rod dia = 32 mm  
Stroke = 20 mm  
Operating pressure : max 250 bar/min 10 bar  
Medium :Hydraulic oil  
(servo system HLP46/HLP68)

| REVISION |     |      |    |      |
|----------|-----|------|----|------|
| ZONE     | REV | FRDM | TD | DATE |
|          |     |      |    |      |

optional against order only

| SURFACE FINISH                          | 0.025 | 0.05 | 0.1 | 0.2 | 0.4 | 0.8 | 1.6 | 3.2 | 6.3 | 12.5 | 25 | 50 | 100 |
|---|-------|------|-----|-----|-----|-----|-----|-----|-----|------|----|----|-----|
| LINEAR - LENGTH OR DIAMETER             |       |      |     |     |     |     |     |     |     |      |    |    |     |
| ANGULAR-LENGTH IN MM OF SHORT SIDE OF ∠ |       |      |     |     |     |     |     |     |     |      |    |    |     |

GENERAL TOLERANCES WHERE NOT SPECIFIED

|          |                                 |
|----------|---------------------------------|
| SCALE:   | 1:1                             |
| TITLE    | BLOCK CYLINDER<br>DOUBLE ACTING |
| NAME     | DATE                            |
| DESIGN   | 22.08.08                        |
| DRAWN    | 22.08.08                        |
| CHECKED  |                                 |
| APPROVED |                                 |

MATERIAL: XXX  
GROUP NO:  
SUPERCEDED BY:  
REPLACES:  
DRAWING NO: -

- 1.0 GENERAL
- 1.1 ALL DIMENSIONS ARE IN MM.
- 1.2 DO NOT SCALE THE DRG.IF IN DOUBT ASK.
- 1.3 SUBJECT TO CHANGE FOR IMPROVEMENT.